

EFC MODULE V SUB-ASSEMBLY

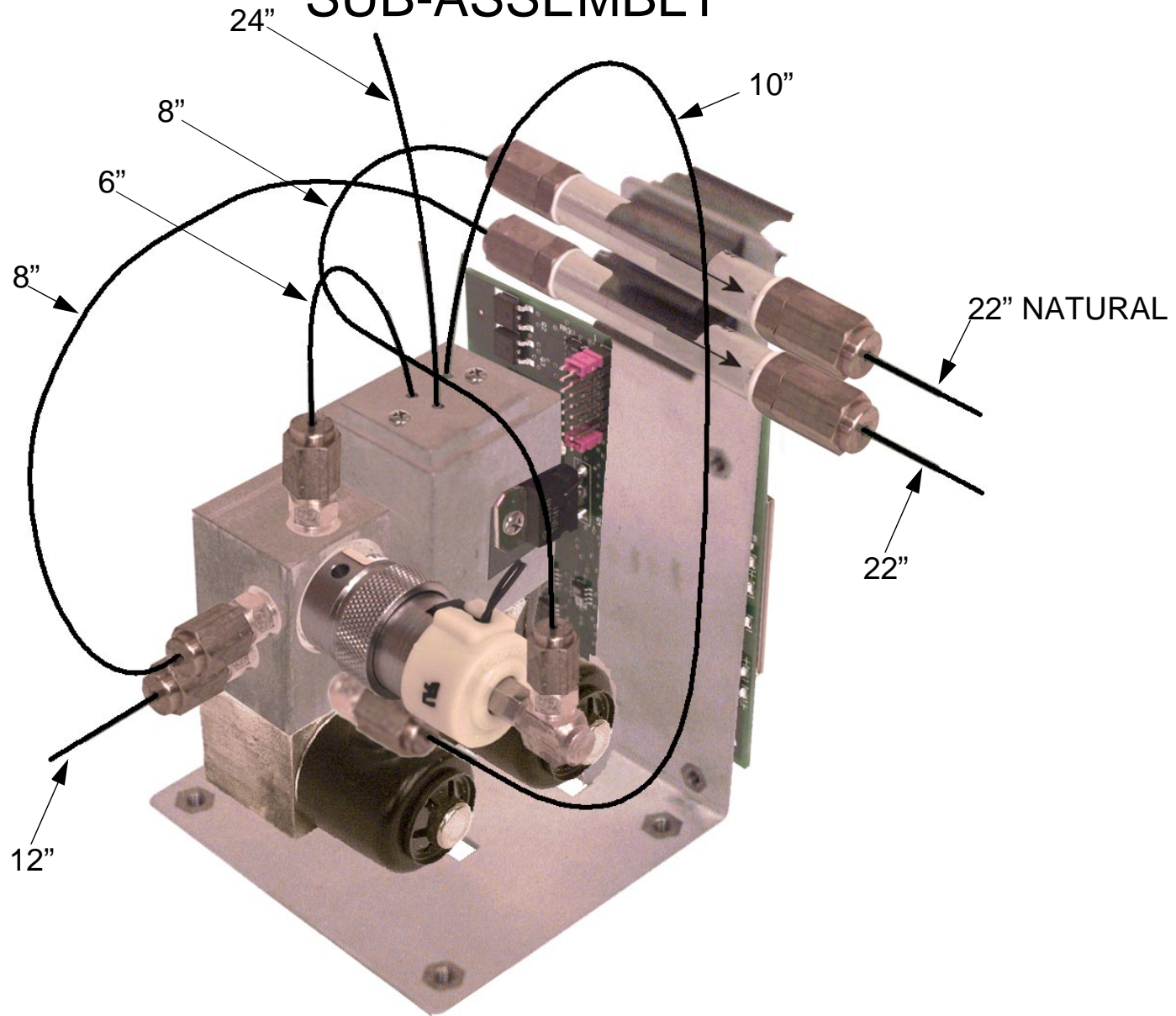

MANIFOLD ASSY.
GOTO PAGE 3

MANIFOLD ASSY.
GOTO PAGE 4

FILTER ASSY.
SEE FILTER SUB-ASSEMBLY

DETAIL A
PWA JUMPER SETTINGS

NOTES: (UNLESS OTHERWISE SPECIFIED)
1. SEE O-RING PRE-ASSEMBLY INSPECTION PROCEDURE.

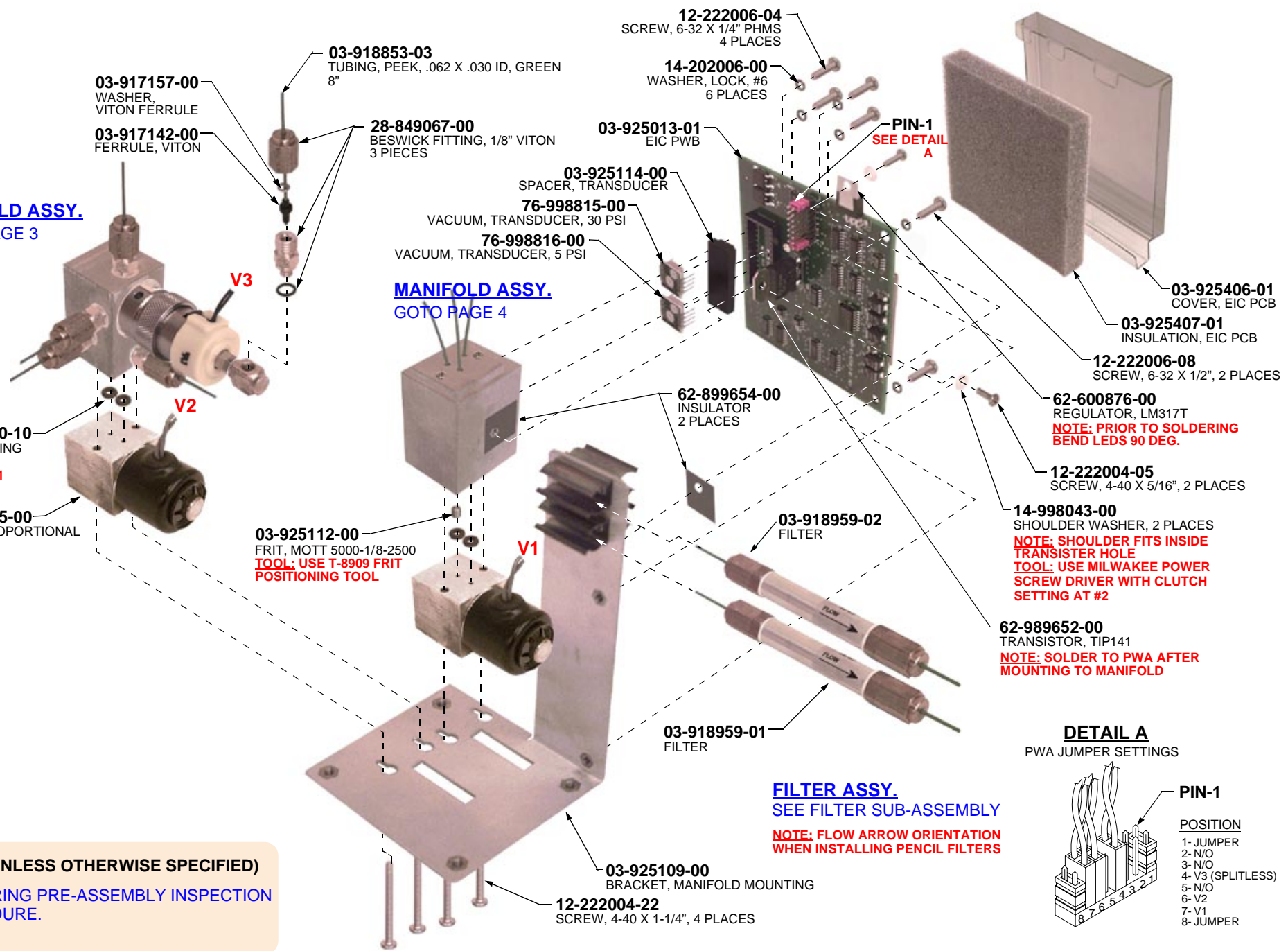

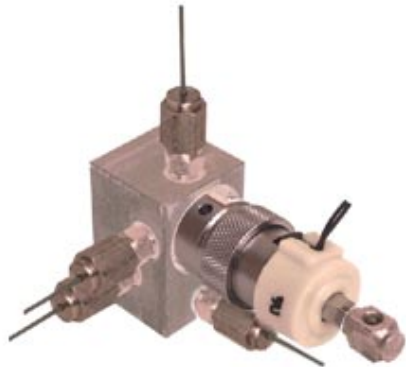

MANIFOLD ASSY.
GOTO PAGE 2 FOR
INSTALLATION

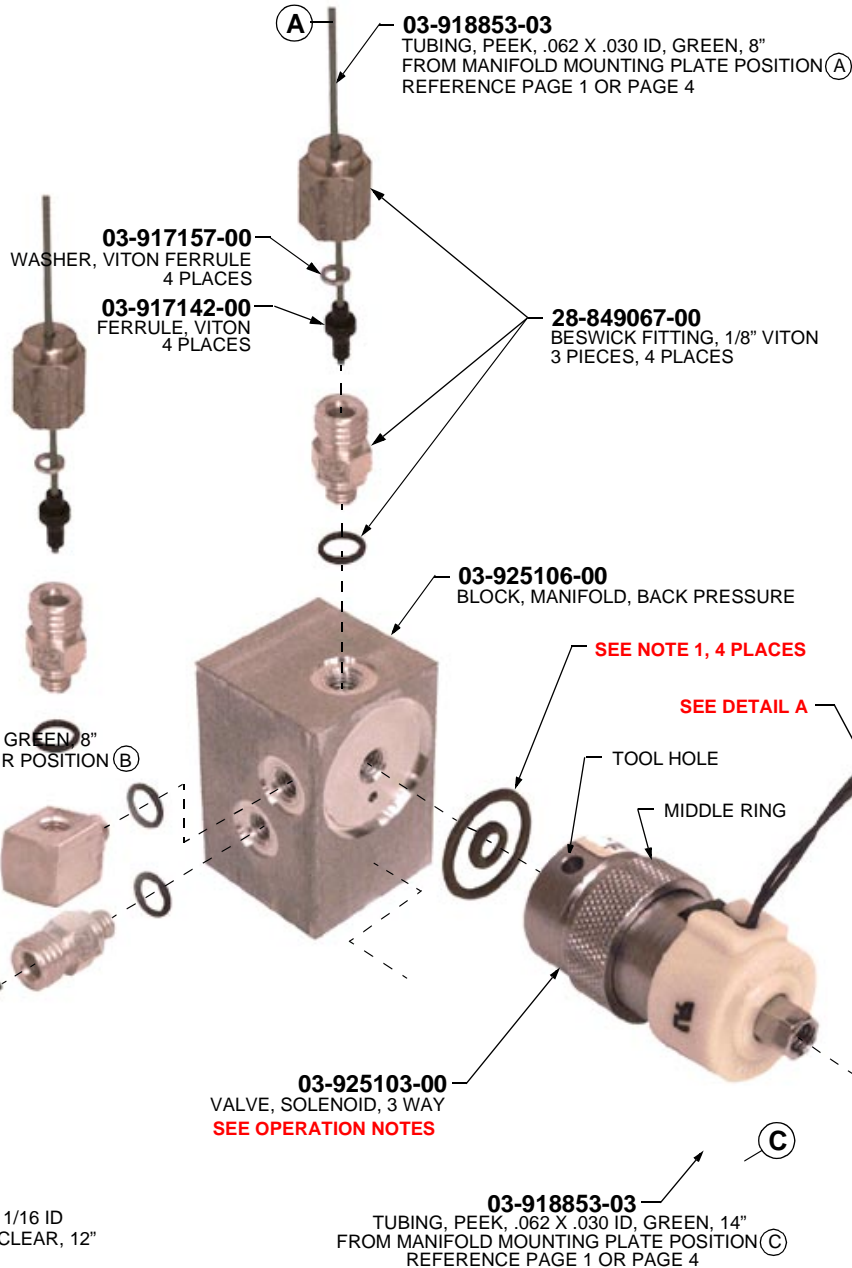

DETAIL A
WIRE TERMINATION

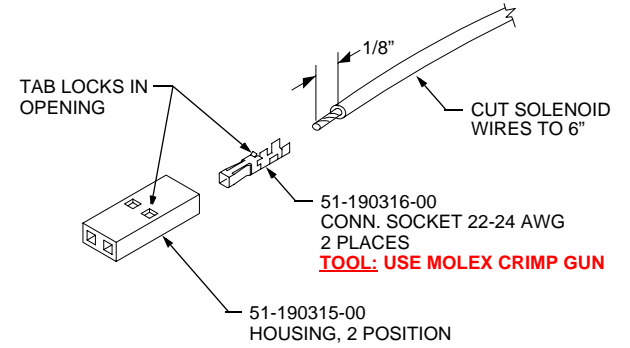

NOTES: (UNLESS OTHERWISE SPECIFIED)

1. SEE O-RING PRE-ASSEMBLY INSPECTION PROCEDURE.

OPERATION NOTES, SOLENOID VALVE ASSY.

2. THE SOLENOID VALVE MIDDLE RING MUST BE LOOSE BEFORE ASSEMBLY.
3. AFTER CLEANING O-RINGS, MANIFOLD AND SOLENOID VALVE MATING SURFACES, HAND TIGHTEN SOLENOID VALVE TO MANIFOLD BLOCK.
4. INSERT SPECIAL TOOL IN TOOL HOLE AND HAND TIGHTEN FURTHER.
5. POSITION VALVE OUTLET (ELBOW FITTING) IN VERTICAL POSITION AND TIGHTEN MIDDLE RING.



MANIFOLD ASSY.
GOTO PAGE 2 FOR
INSTALLATION

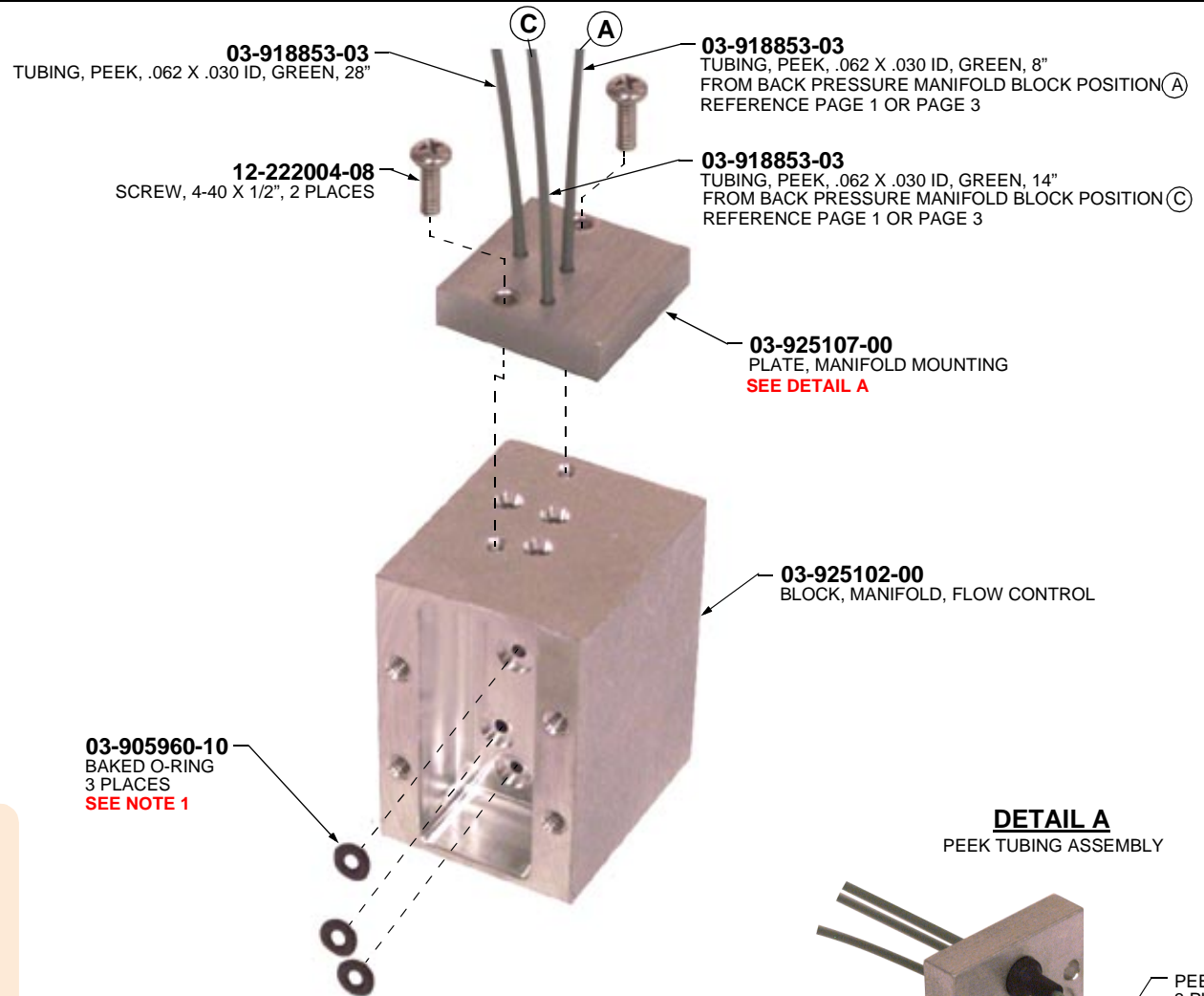

DETAIL A
PEEK TUBING ASSEMBLY

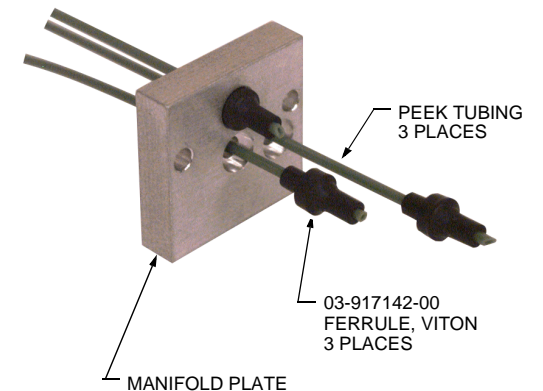

NOTES: (UNLESS OTHERWISE SPECIFIED)

1. SEE O-RING PRE-ASSEMBLY INSPECTION PROCEDURE.

OPERATION NOTES

2. AFTER CLEANING O-RINGS AND MANIFOLD MATING SURFACE, SET O-RINGS IN PLACE WITH TWEEZERS (DO NOT TOUCH O-RINGS).
3. FIRMLY SEAT O-RINGS IN THE MANIFOLD BLOCK.
4. INSPECT SEATING OF O-RINGS, IF NECESSARY PRESS TO SEAT USING TWEEZERS.
5. AFTER O-RING PLACEMENT "DUST-OFF" AGAIN.